



The Low Power Programmable Leader

Corporate Overview

May 2025

Safe Harbor Statement

Forward Looking Statements

This presentation may contain forward-looking statements within the meaning of the Private Securities Litigation Reform Act of 1995 and made pursuant to the safe harbor provisions of Section 27A of the Securities Act of 1933, as amended, and Section 21E of the Securities Exchange Act of 1934, as amended. These statements involve estimates, assumptions, risks and uncertainties. Any statements about our expectations, beliefs, plans, objectives, assumptions or future events or performance are not historical facts and may be forward-looking. Such forward-looking statements include, but are not limited to, statements relating to our strategy; product roadmap; new applications of our products; long-term financial model; revenue growth; design win growth; market improvement; new greenfield growth opportunities; our market position; our ability to solve customer challenges; and growth in our customer base. Other forward-looking statements may be indicated by words such as “will,” “could,” “should,” “would,” “may,” “expect,” “plan,” “project,” “anticipate,” “intend,” “forecast,” “future,” “believe,” “estimate,” “predict,” “propose,” “possible,” “potential,” “continue,” “ongoing,” or the negative of these terms or other comparable terminology. Factors that may cause actual results to differ materially from the forward-looking statements in this presentation include global economic conditions which may affect customer demand, the cyclical nature of the semiconductor industry, pricing and inflationary pressures, competitive actions, international trade disputes and sanctions, the impact of tariffs, and the potential impact of global pandemics, and other significant risks and uncertainties that are beyond our ability to predict or control, including those risks more fully described in our filings with the Securities and Exchange Commission, including Item 1A in Lattice’s most recent Annual Report on Form 10-K, especially those under the captions “Risk Factors” and “Management’s Discussion and Analysis of Financial Condition and Results of Operations”, all of which are expressly incorporated herein by reference.

You should not unduly rely on forward-looking statements because actual results could differ materially from those expressed in any forward-looking statements. In addition, any forward-looking statement applies only as of the date on which it is made. We do not intend to, and undertake no obligation to, update or revise any forward-looking statements, whether as a result of events or circumstances after the date hereof or to reflect the occurrence of unanticipated events.

Use of non-GAAP Financial Information

To supplement the Company’s financial statements presented on a GAAP basis, we have provided non-GAAP financial information in this presentation, including non-GAAP gross margin, gross margin percentage, earnings per share, operating profit, adjusted EBITDA, adjusted EBITDA margin, R&D expense, SG&A expense, and operating expenses. Non-GAAP financial information is not meant as a substitute for GAAP results but is included because management uses such information to evaluate and manage the Company and believes such information is useful to our investors for informational and comparative purposes. These non-GAAP measures should be considered in addition to, and not as a substitute for, the results prepared in accordance with GAAP. See the Appendix in our Q4’24 and Q1’25 earnings reports for reconciliation to most comparable GAAP measure.

Trademarks – General Notice

Lattice Semiconductor Corporation, Lattice Semiconductor (& design) and specific product designations are either registered trademarks or trademarks of Lattice Semiconductor Corporation or its subsidiaries in the United States and/or other countries.

Agenda

1



Company Overview

2



Products & Solutions

3



End Markets & Applications

4



Financials

Our Mission



The Low Power Programmable Leader

Lattice Semiconductor Overview

APPLICATIONS & MARKETS

We enable secure control, flexible connectivity, and low power compute acceleration



COMMUNICATIONS
& COMPUTING

45%



INDUSTRIAL &
AUTOMOTIVE

46%



CONSUMER

9%

WORLD CLASS SUPPLIER

#1

World's largest volume
supplier of FPGA

Tier 1

Supplier with 40+ years
of innovation



GROWING CUSTOMER BASE



GLOBAL SUPPORT



Lattice Executive Leadership Team



Ford Tamer
CEO



Pravin Desale
Research & Development



Esam Elashmawi
CSMO



Tracy Feanny
General Counsel



Lorenzo Flores
CFO



Divyesh Shah
Operations & Quality



Erhaan Shaikh
Sales



Nicole Singer
Human Resources

Holding Ourselves to the Highest Corporate Stewardship Standards

CULTURE OF INNOVATION



ENVIRONMENTALLY CONSCIOUS



INCLUSION & SOCIAL WELLBEING

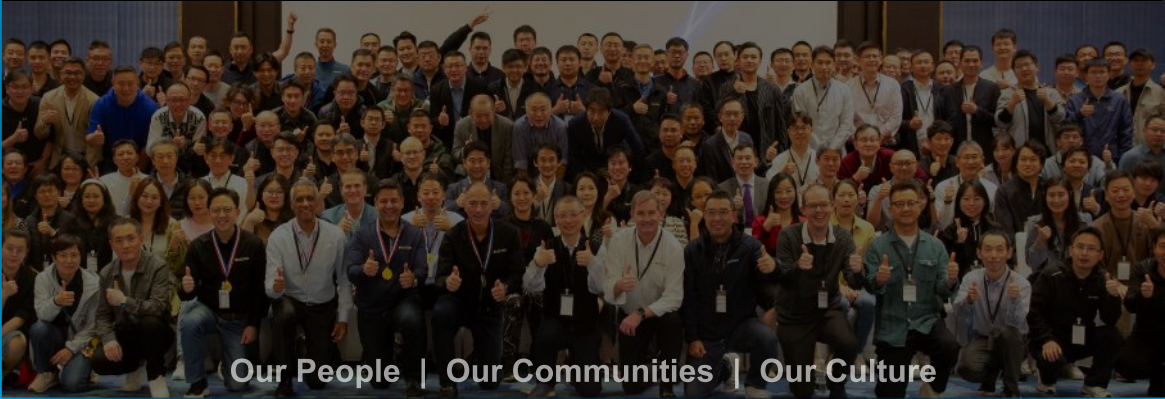

TRANSPARENCY & INTEGRITY



GSA MOST RESPECTED PUBLIC COMPANY FIVE YEARS IN A ROW



STRONG & GROWING RECOGNITION FOR CLEANTECH PRODUCT INNOVATION



Agenda

- 1 Company Overview
- 2 Products & Solutions**
- 3 End Markets & Applications
- 4 Financials

Lattice Value Proposition



The Low Power Programmable Leader

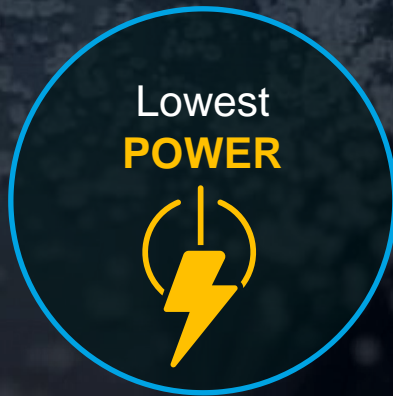

Lattice FPGA Portfolio

PLATFORM	DEVICE FAMILIES					
----------	-----------------	--	--	--	--	--

LATTICE
AVANT™



Avant™E

Edge-optimized
Processing



Avant™G

Cutting-edge General
Purpose Processing



Avant™X

Advanced
Connectivity

LATTICE
NEXUS 2



LAUNCHED DEC. 2024

ADVANCED GENERAL PURPOSE SMALL FPGAs

SYSTEM EXPANDABILITY

A server rack and an industrial robotic arm.

SECURE BRIDGING

A network tower and a car dashboard with a heads-up display.

LATTICE
NEXUS™



CrossLink™NX

Embedded Vision
Processing



Certus™NX

General Purpose
Processing



Mach™NX

Next Gen Hardware
Security



CertusPro™NX

Advanced General
Purpose Processing



MachXO5™NX

Enhanced System
Monitor and Control



MachXO5T™NX

Advanced System
Control



CrossLinkU™NX

Embedded Vision
Processing with USB

FPGA PLATFORM LEADERSHIP



Architected for applications requiring up to 16G SERDES and up to 200k LCs



Architected for applications requiring up to 25G SERDES and up to 500k LCs



**LOWER
POWER**



**FASTER
PERFORMANCE**



**SMALLER
SIZE**

Software Solution Stack Portfolio

LATTICE
sensAI™



Low Power Edge AI

High Performance
Inferencing Under 1W

Supports Industry Standard
ML Frameworks

Complete Solution
Enablement

LATTICE
mVision™



Low Power Embedded Vision

Flexible Image Sensor
Bridging & Aggregation

Image Processing
Integration

Complete Solution
Enablement

LATTICE
Sentro™



Cyber Resilient Root of Trust

Secure Hardware Creates
Root-of-Trust for Systems

Cryptographically Secured
Supply Chain

Protection Against Cloning,
Counterfeiting, Trojan
Insertion,
& Simulation

LATTICE
Automate™



Accelerating Factory Automation

Accelerates industrial
automation development

Supports use cases like
motor control, real-time
networking, & predictive
maintenance

Complete solution
enablement

LATTICE
ORAN™



Enabling ORAN Deployment

Enables zero trust security
and data protection in
networks

Flexible, Tight Fronthaul
Synchronization

Acceleration with Low
Power

LATTICE
Drive™



Adaptable Automotive Design

DisplayPort connectivity

Video scaling up to 4K

Local dimming for contrast
enhancement

Bridging & networking

Easy-to-use Software



Powerful FPGA Design & Verification Environment

Easy Design Exploration
Easy to Use Powerful Tools
Optimized for Lattice Devices

Best-in-class, Easy-to-use Design Software

Simplified Flow for Faster Design
Increase Re-use with IP Tools
Leading Synthesis & Simulation

Complete Toolset for Embedded System Design

IP System Integration Environment
Software Development Kit & Libraries
Build, Compile, Analyze, Debug

Advanced Computer Vision Software for the Edge

Security and Privacy Protections
Digital Wellbeing Capabilities
Facilitates Intelligent Collaboration & Productivity

RAPID PRODUCT PORTFOLIO EXPANSION

SOFTWARE SOLUTIONS

LATTICE
sensAI™

LATTICE
mVision™

LATTICE
Sentro™

LATTICE
Automate™

LATTICE
ORAN™

LATTICE
Drive™

LATTICE
DIAMOND
DESIGN SOFTWARE

LATTICE
PROPEL™

LATTICE
RADIANT™
DESIGN SOFTWARE



IN DEVELOPMENT

MID-RANGE FPGAs

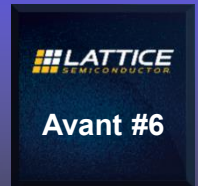

IN DEVELOPMENT

SMALL FPGAs



...



IN DEVELOPMENT

IN PLANNING



IN DEVELOPMENT

Agenda

- 1 Company Overview
- 2 Products & Solutions
- 3 End Markets & Applications**
- 4 Financials

Innovation Leadership From Edge to Cloud

DATACENTER



Top 10 Server &
Storage Providers

COMMUNICATIONS



10 Leading
Comms OEMs

INDUSTRIAL



Top 10 Factory
Automation Leaders

AUTOMOTIVE



10 Leading
Auto OEMs

CLIENT



Top 5 PC OEMs -
>50MU Shipped

Lattice is the #1 Supplier for Small FPGAs Worldwide

Lattice Solves Datacenter Challenges

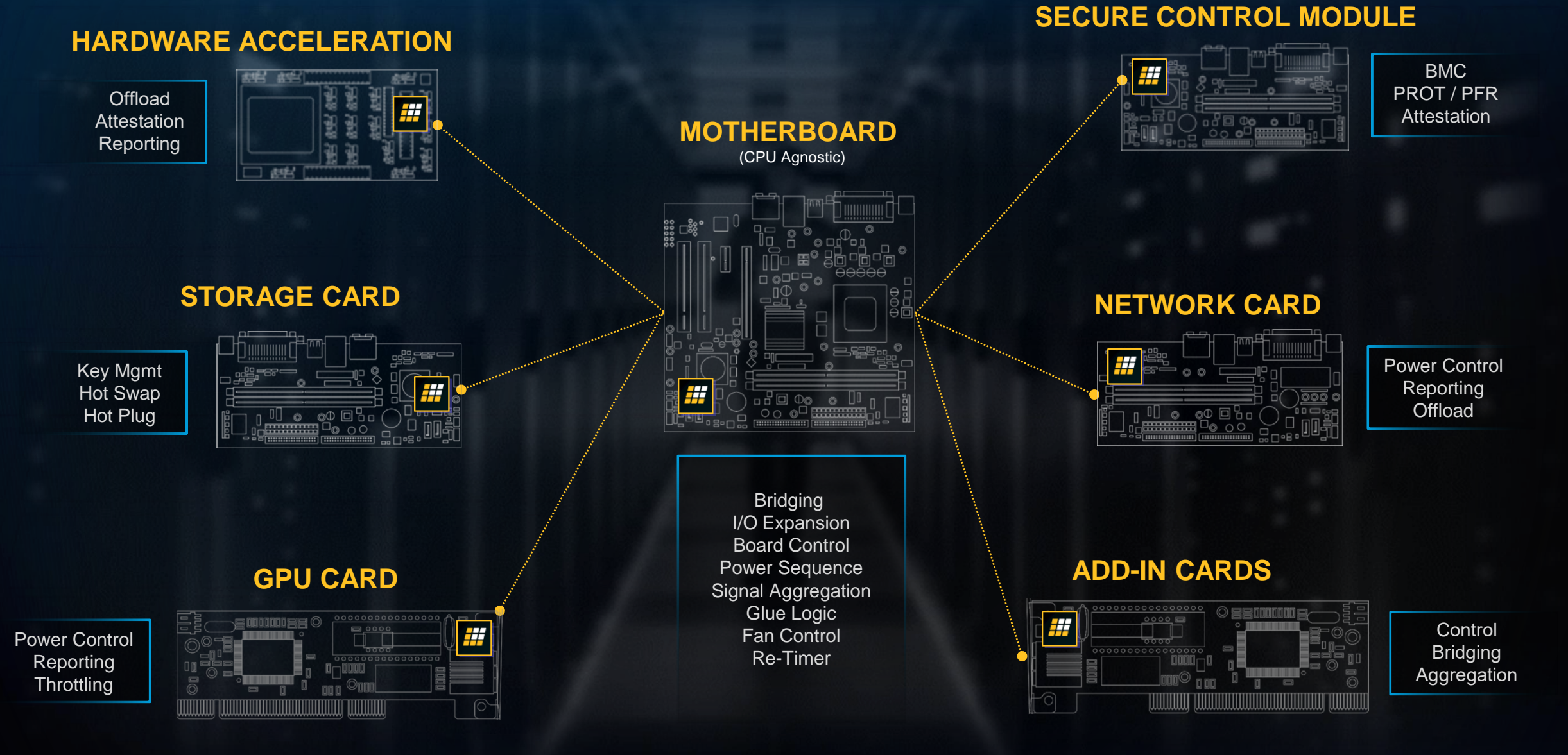

Lattice Solves Communications Challenges

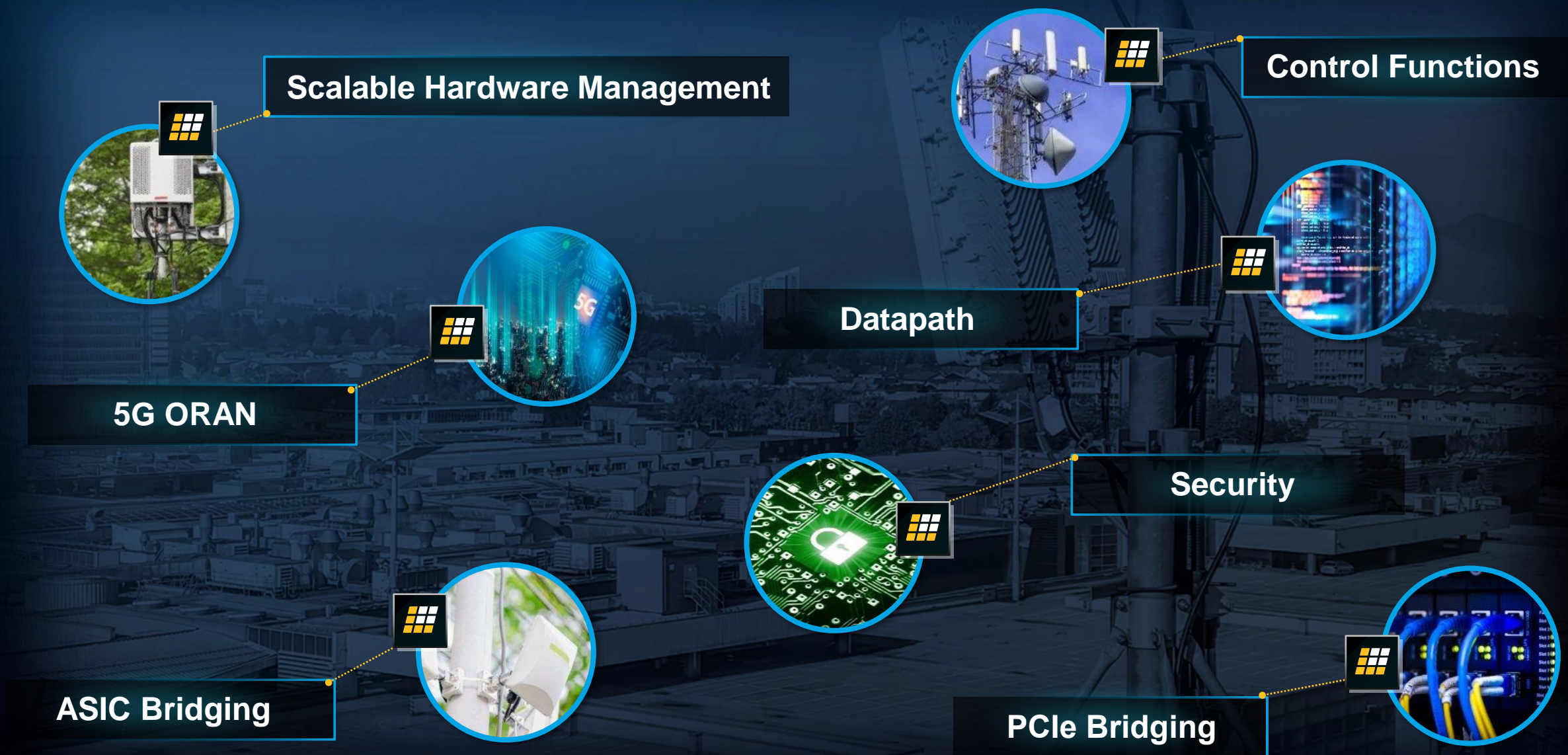

Lattice Solves Industrial Challenges



Smart Factory

- Collision Avoidance
- Edge Computing
- Functional Safety
- Industrial Networking
- Machine Vision
- Motor Control
- Predictive Maintenance
- Programmable Logic Control
- Object Identification
- Sensor Fusion
- Robotics



Test & Measurement

- High-Speed Data Acquisition
- Signal Processing
- Emulation and Validation
- Pattern Generation and Analysis
- Timing Analysis
- Error Detection and Correction
- Jitter and Noise Measurement
- Power Analysis
- Temperature and Stress Testing
- Portables and Handhelds



Medical

- Digital Endoscopy Systems
- MRI and CT Image Processing
- Ultrasound Signal Processing
- Electrocardiogram Signal Processing
- X-ray Processing
- Blood Analysis Equipment
- Health Monitors
- Robotic Surgery Assistants
- Secure Medical Data Processing
- Patient Monitoring Systems



Aerospace & Defense

- Radar Signal Processing
- Avionics Control Systems
- Digital Beamforming
- Satellite Communications
- GPS and Navigation Systems
- Infrared and Optical Image Processing
- Ruggedized Systems for Harsh Environments
- Secure Communications



Broadcast / ProAV

- Video Encoding/Decoding
- Live Video Streaming
- High-Resolution Video Processing
- Video Scaling and De-interlacing
- Color Correction and Enhancement
- Image Stabilization
- Audio Processing and Mixing
- Multi-Protocol Bridging
- Real-Time Graphics Overlays
- Low-Latency Switching

Lattice Solves Human Machine Interface Challenges

Gesture Detection



Person Detection



Attention Sensing

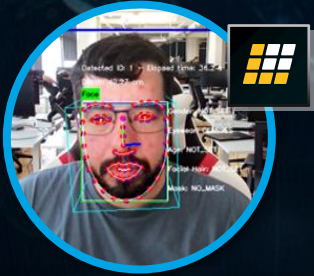

Enhanced Security



Driver Monitoring



Audio/Visual User ID

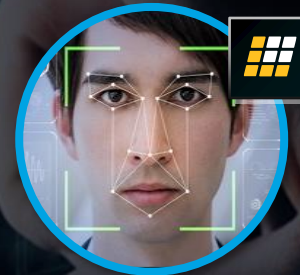

Lattice Solves Automotive Challenges

INFOTAINMENT

- De-Fog
- 360° Surround View
- Display Bridging
- ISP

IN-CABIN AI

- Human Presence Detection
- Driver Monitoring

ADAS

- Radar Sensor Bridging & Aggregation
- Image Sensor Bridging & Aggregation

HYBRID/ELECTRIC

Inverter / Charger

SECURITY

- Secure Battery Mgt.
- Secure Boot

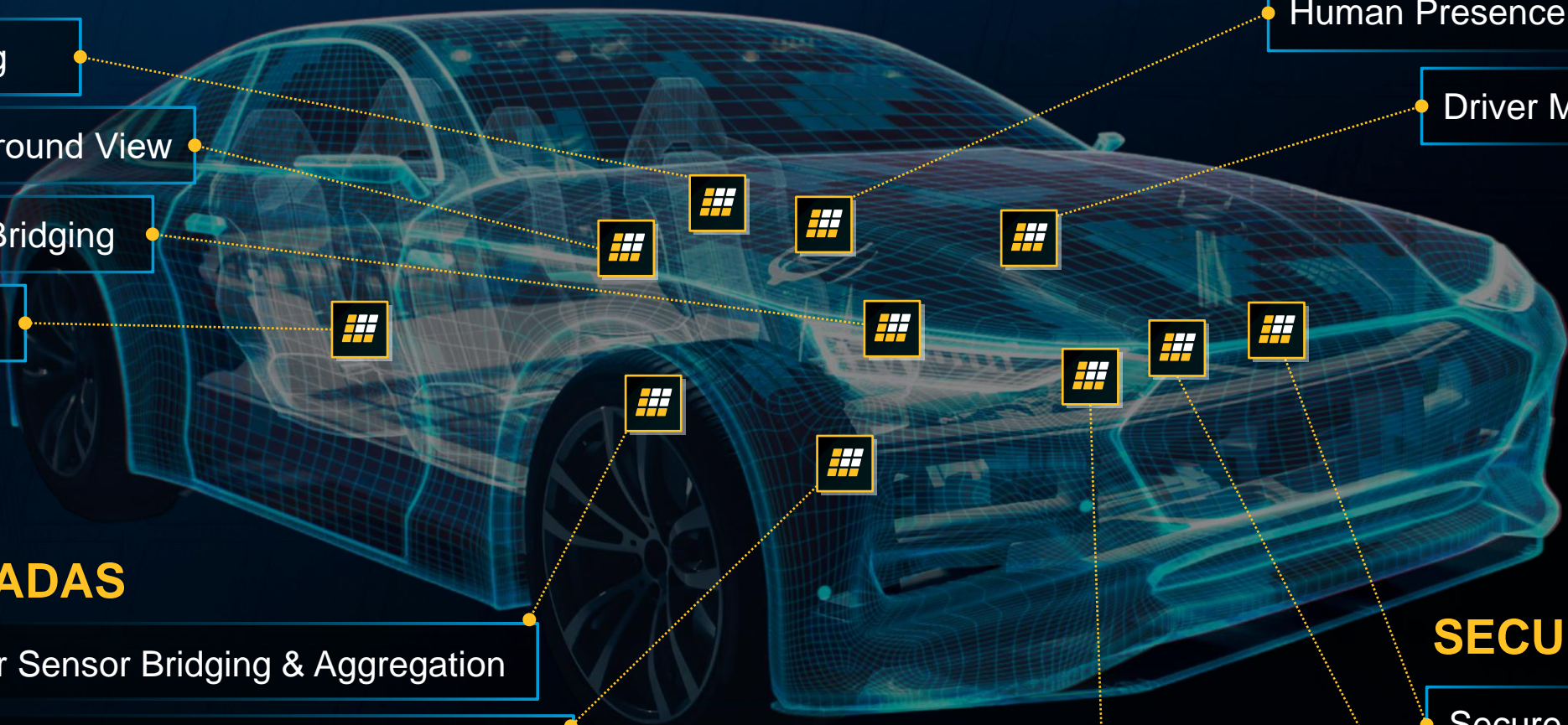

Lattice Solves Consumer Challenges

Drones



AR / VR



Smart Speaker



Smart Appliance



Consumer Robots



Video Surveillance



Wearable



Smart Doorbell



Smart Toys



Lattice Drives AI Innovation

Gen AI Servers



Leading Control and Security in AI Servers

Up to >50 FPGAs
per server rack

Deployed at majority of
Hyperscalers and OEM/ODMs

Sensor Proliferation

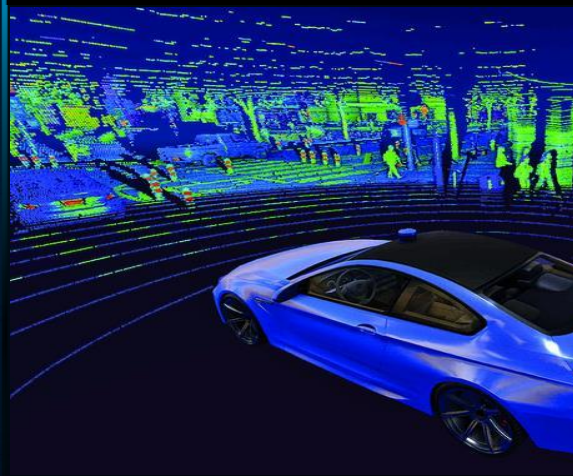

Data Fusion and Optimized Streaming

Partnership with Nvidia to
simplify sensor connectivity

Diverse sensor connectivity in
autonomous systems

Intelligent Edge



Low Power Vision Processing

40M+ devices shipped with
advanced computer vision
experiences

Shipping at top Client OEMs

Enabling AI from hybrid cloud to the intelligent edge with low power FPGAs and software

Agenda

- 1 Company Overview
- 2 Products & Solutions
- 3 End Markets & Applications
- 4 Financials**

Q1 2025 Earnings Overview & Highlights

REVENUE

\$120.1M

2% Growth QoQ

GROSS MARGIN

69%*

ADJUSTED EBITDA

33.4%*

"The first quarter of 2025 developed as expected, with sequential revenue growth, a record level of design wins, and a further expansion of our operating margins. Revenue and design win growth are being led by new applications, notably in generative AI in the datacenter, robotics in industrial, in-cabin and ADAS in automotive, AR/VR in consumer, security, including post-quantum cryptography, and far edge AI for lower power applications. While we are encouraged by our progress, we are monitoring the market environment, along with the broader industry, as it could have an impact on our second half of 2025 outlook." – Ford Tamer, CEO

End Market Overview

Q1'25 REVENUE
BY SEGMENT (%)

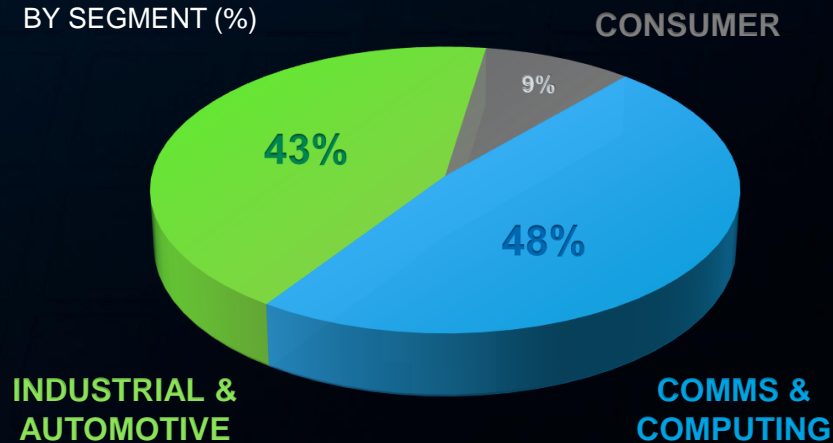

Highlights

- Q1'25 revenue grew sequentially; guiding Q2'25 midpoint revenue growth
- Record design wins in Q1'25
- Industrial & Automotive grew sequentially
- Server revenue grew sequentially and year-over-year, and is expected to grow in Q2'25 due to expanding content in general purpose servers and AI-optimized servers

FY 2024 Financial Overview

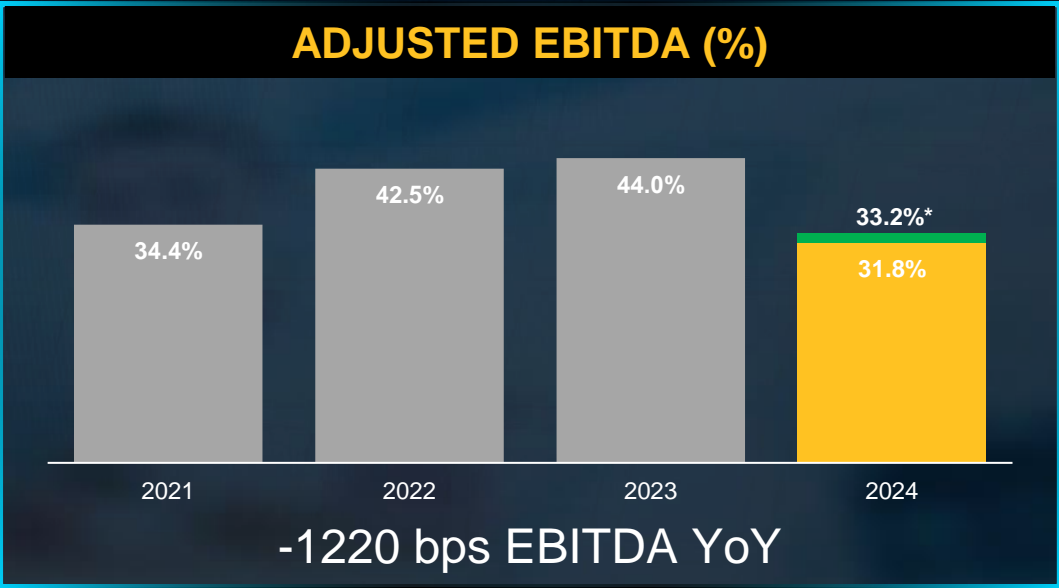
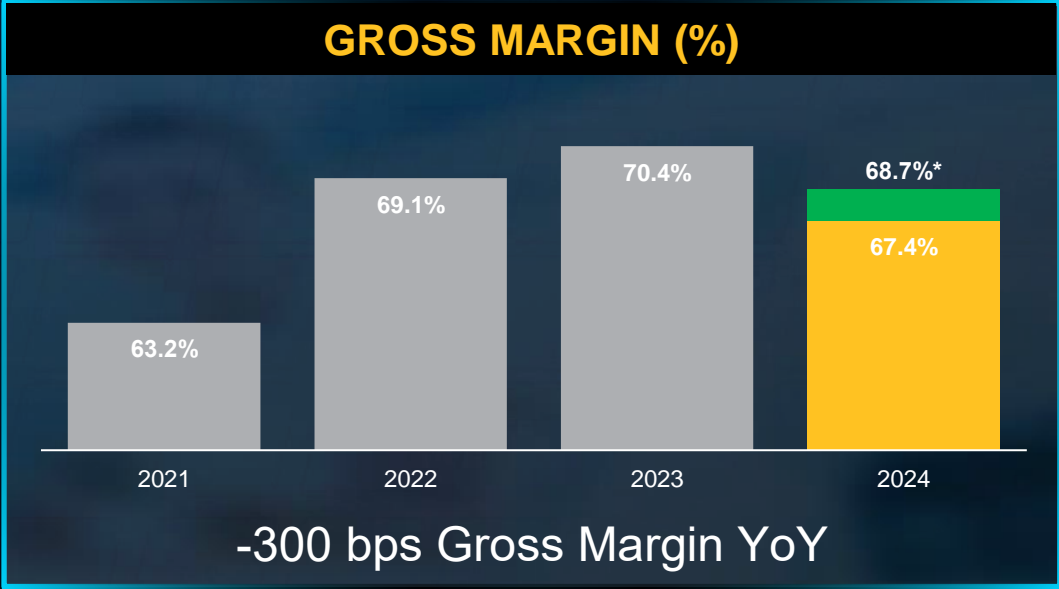
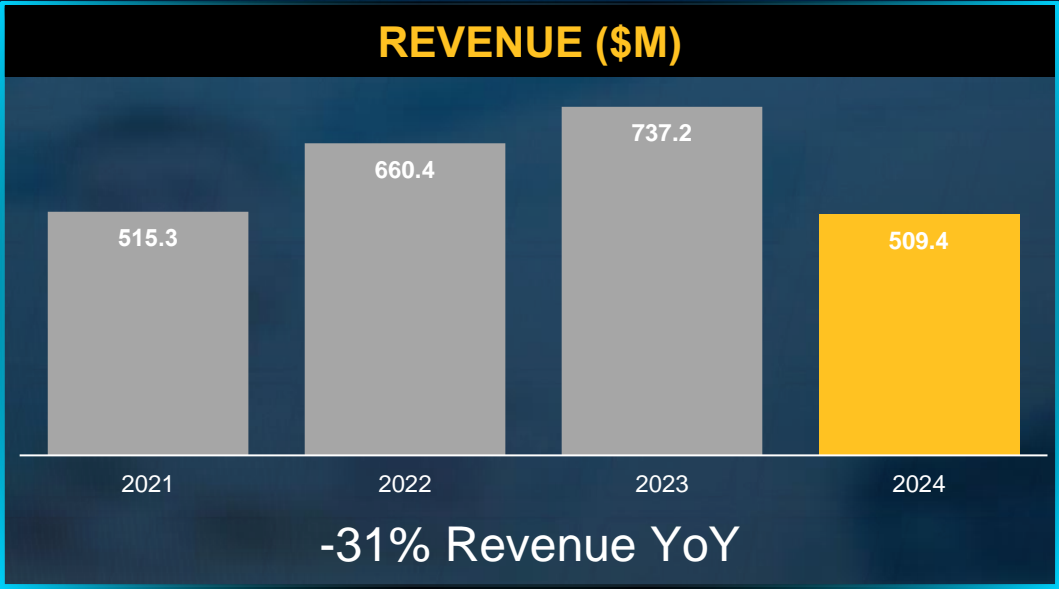



The Low Power Programmable Leader